

MANUAL

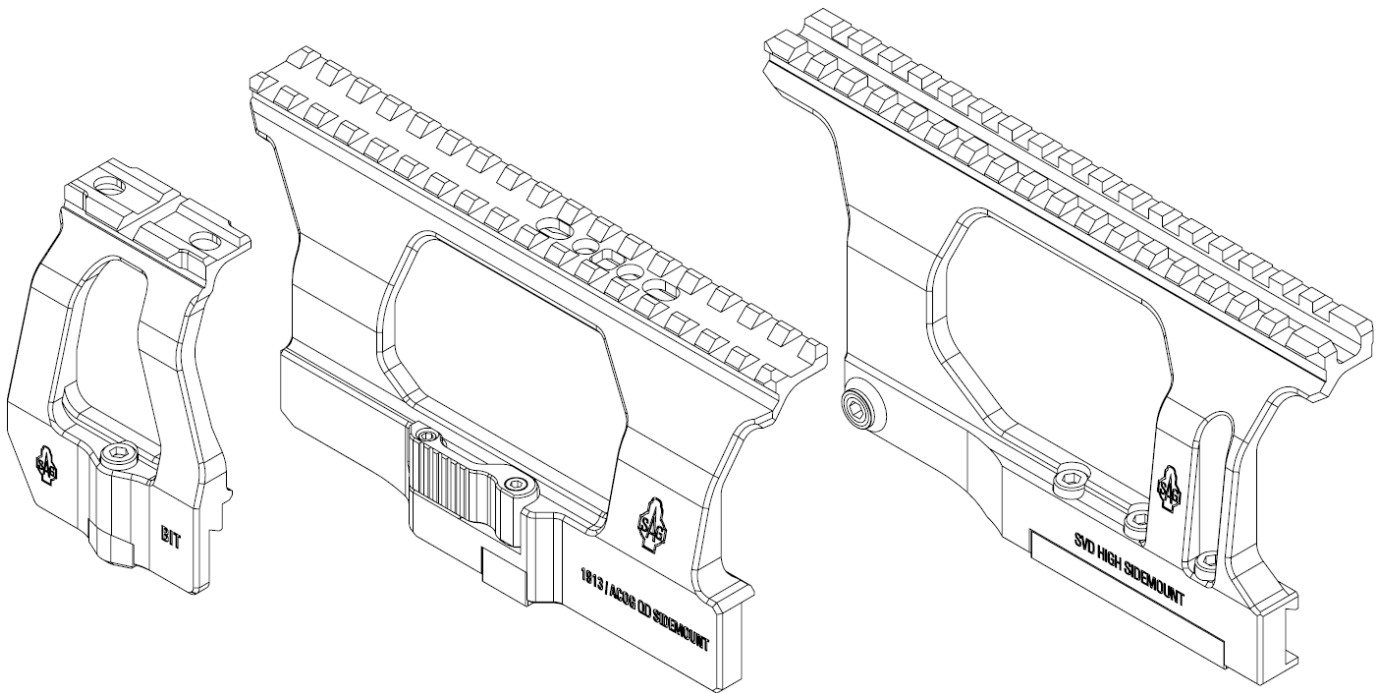

SURESHOT ARMAMENT

SIDEMOUNTS



Sureshot Armament Group, 2022

sureshot-armament.com

Contents

Sidemount for AK QD	3
Sidemount for AK	6
Sidemount for AK BIT	8
Sidemount for SVD high	10
Sidemount for SVD low	12

SIDEMOUNT FOR AK QD

Design

art.: S20018

The locking mechanism consist of three parts:

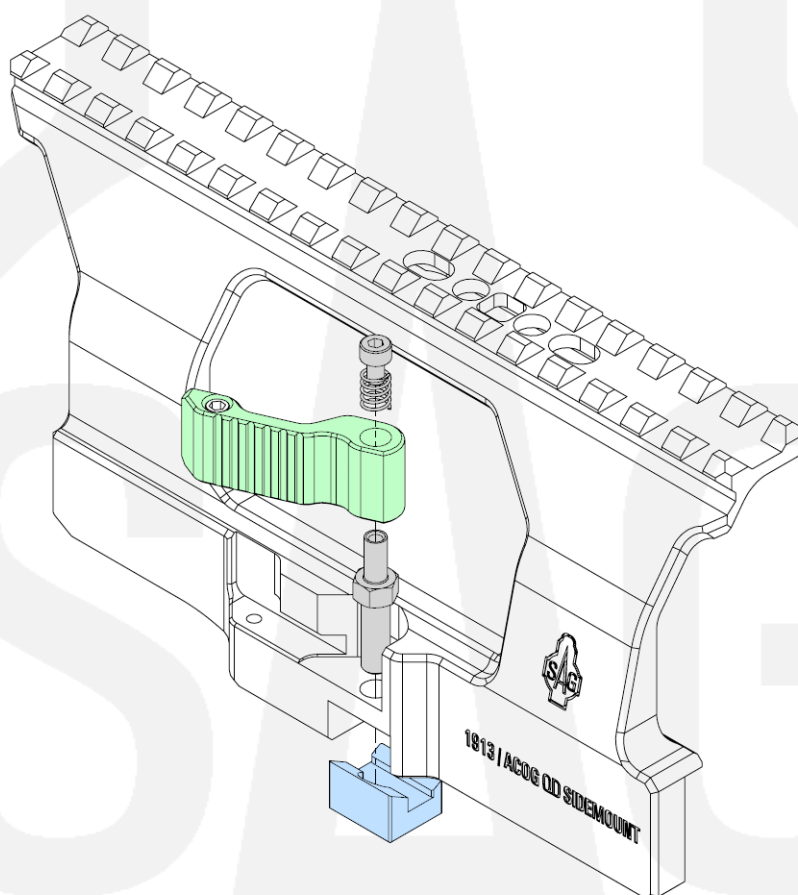

■ rotating lever ■ clamping bar ■ proprietary locking bolt

Mounting method

The sidemount is secured to the receiver side rail in this way:

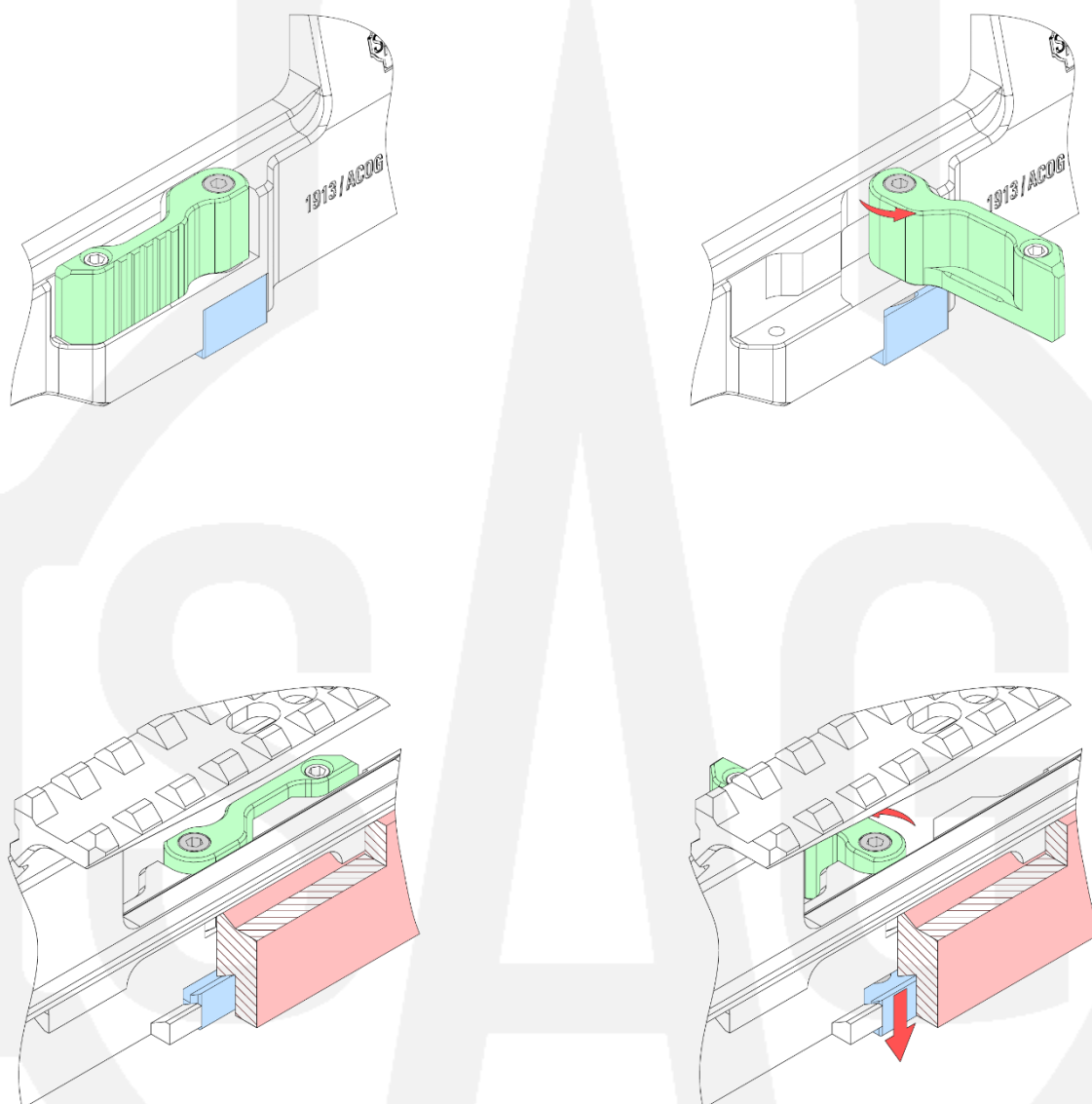

■ rotating lever ■ clamping bar ■ proprietary locking bolt ■ side rail

Adjustment

Adjusting mount tension:

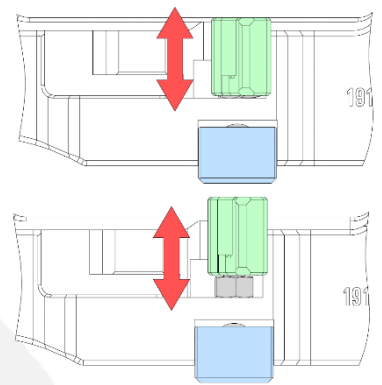

1. Open

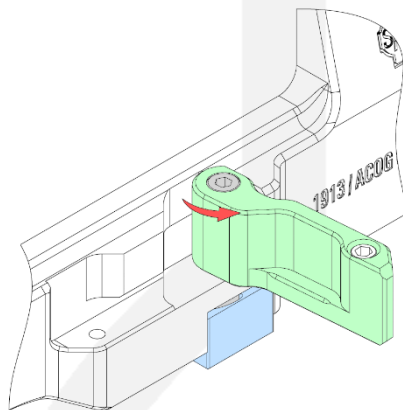

2. Elevate

(decoupling with the locking bolt)

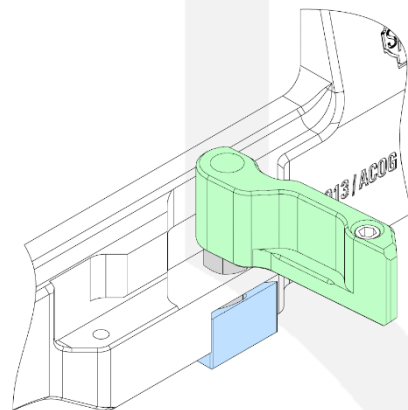

3. Rotate

(loosening/tightening the clamp)

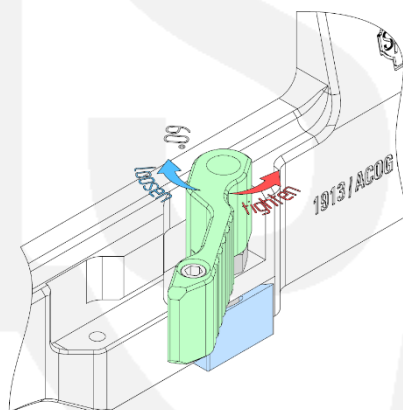

4. Lock

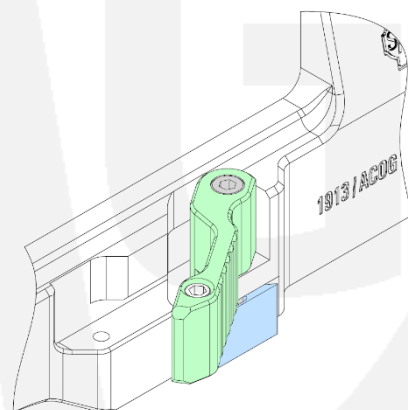

■ rotating lever ■ clamping bar ■ proprietary locking bolt

The lever acts like a spanner wrench.

SIDEMOUNT FOR AK

Design

art.: S20016

The locking mechanism consist of two parts:

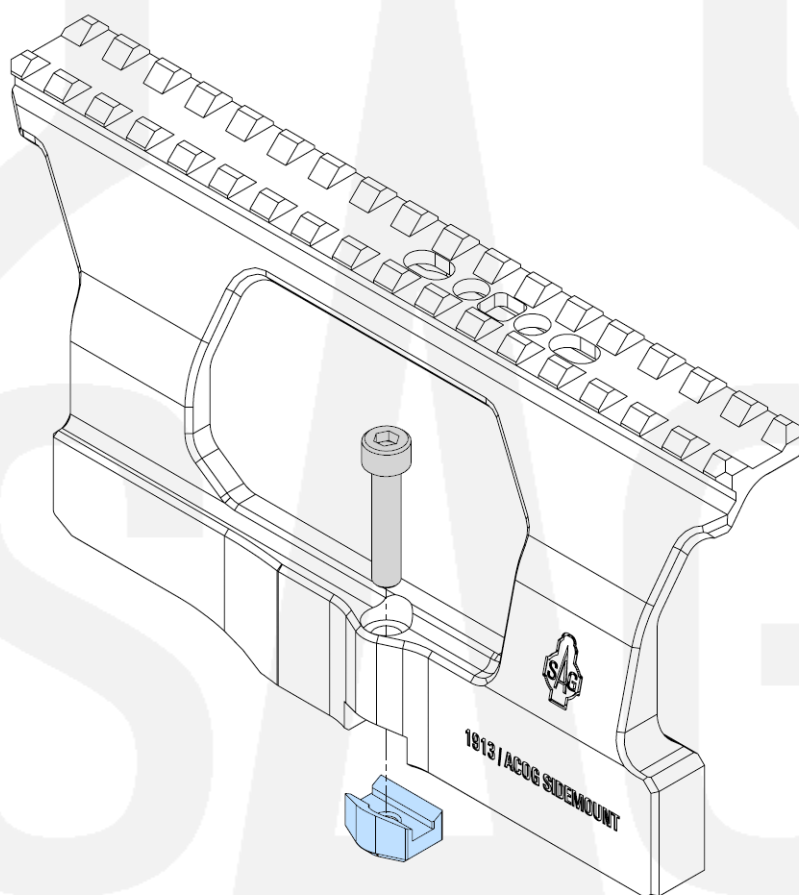

■ clamping bar ■ M5 bolt

Mounting method

The sidemount is secured to the receiver side rail in this way:

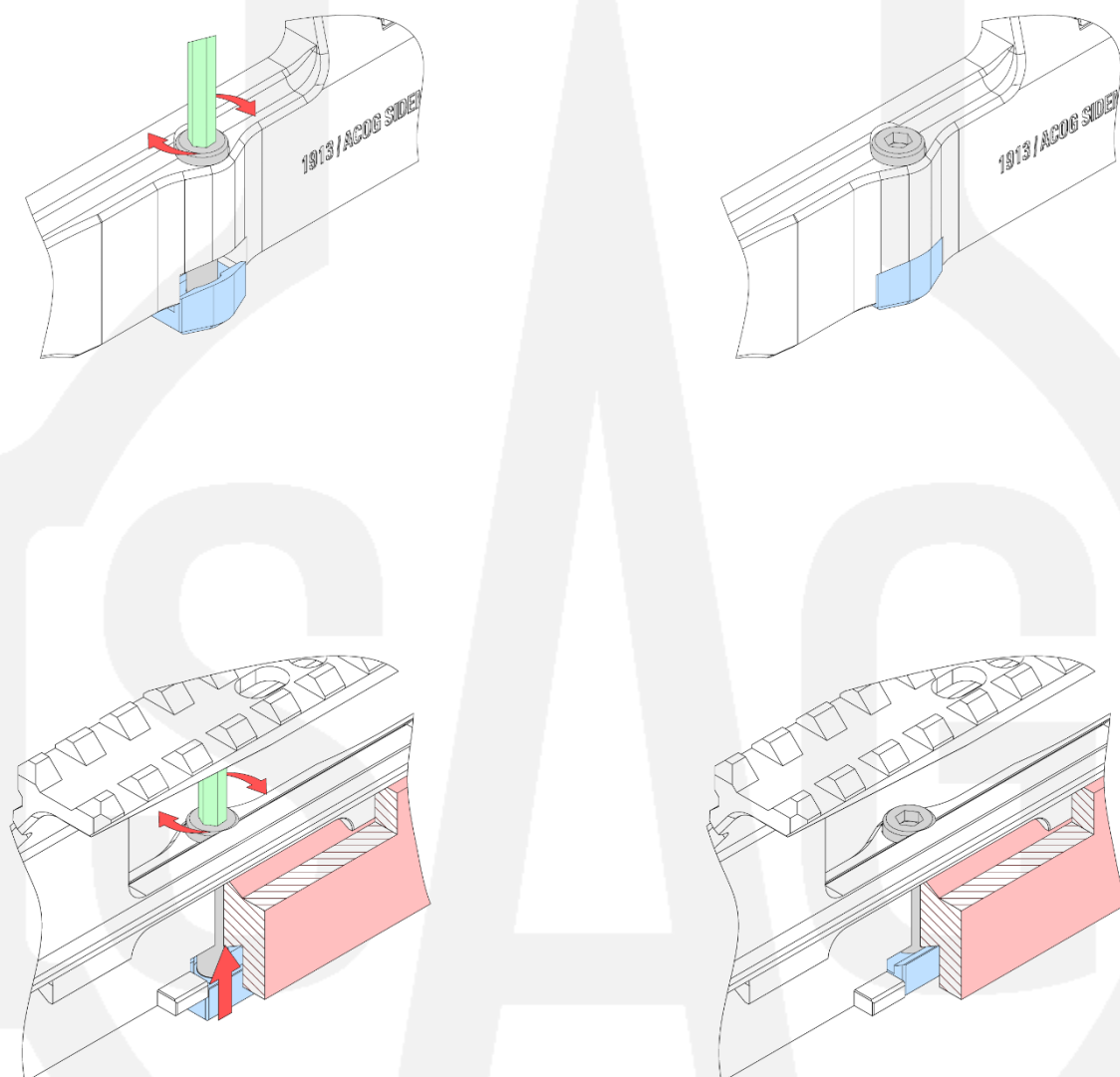

■ clamping bar ■ M5 bolt ■ 4 mm hex key ■ side rail

Tightening torque: 35 inch pounds (4 N·m)

SIDEMOUNT FOR AK BIT

Design

art.: S20019

The locking mechanism consist of two parts:

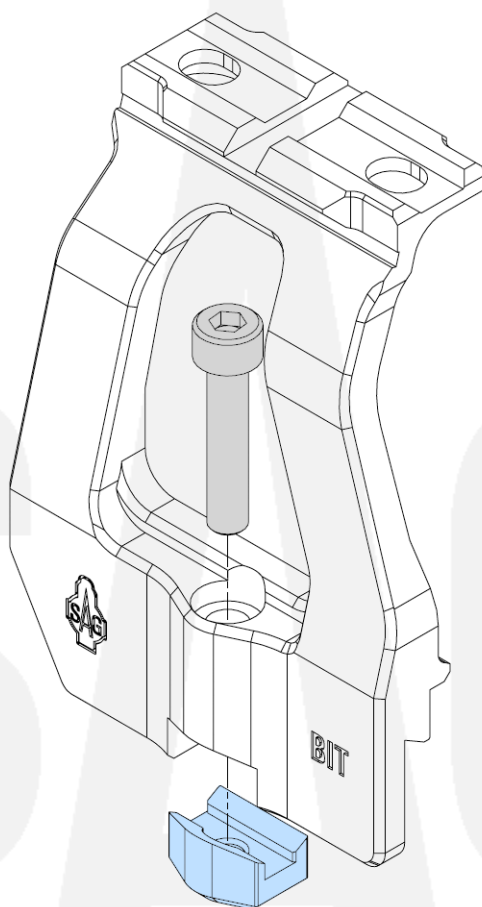

■ clamping bar ■ M5 bolt

Mounting method

The sidemount is secured to the receiver side rail in this way:

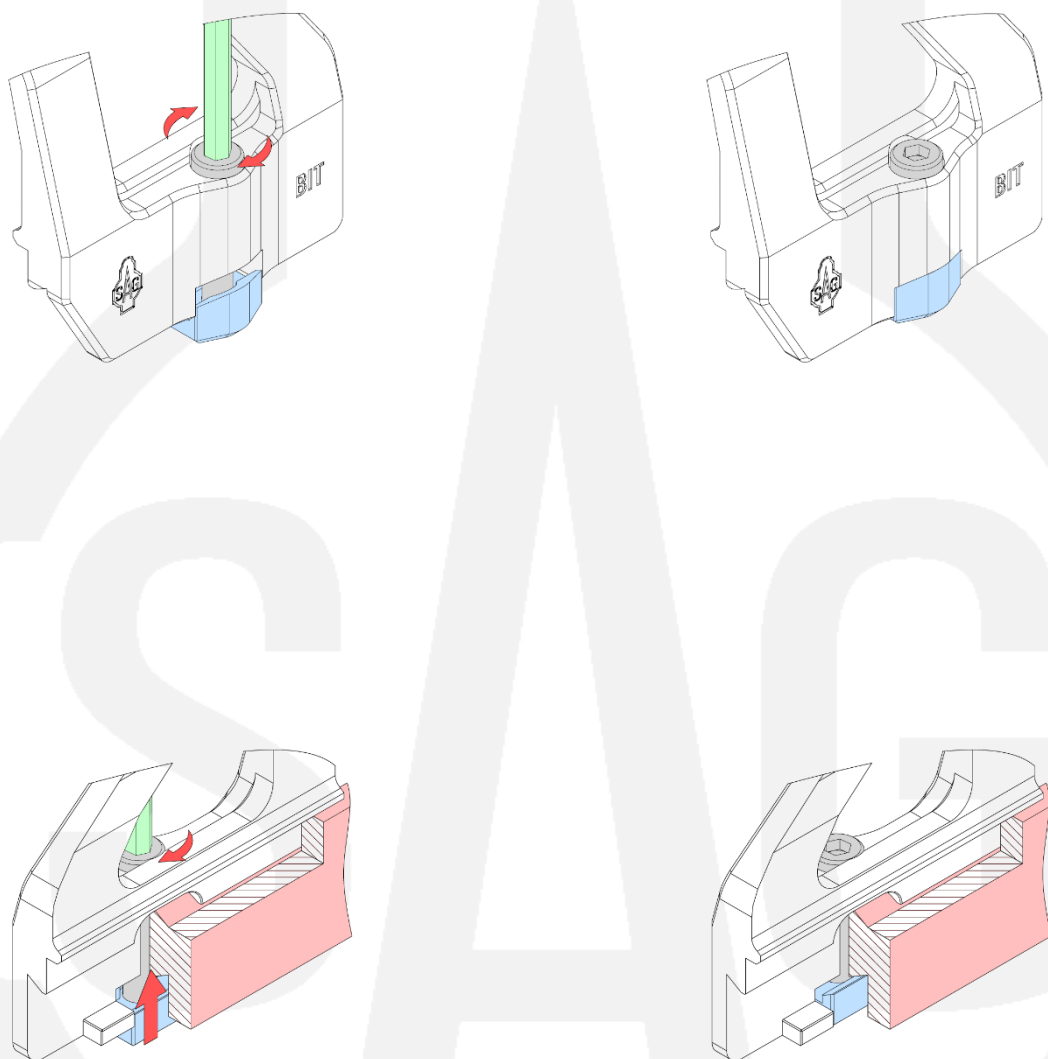

■ clamping bar ■ M5 bolt ■ 4 mm hex key ■ side rail

Tightening torque: 35 inch pounds (4 N·m)

SIDEMOUNT FOR SVD HIGH

Design

art.: S20020

The locking mechanism consist of three parts:

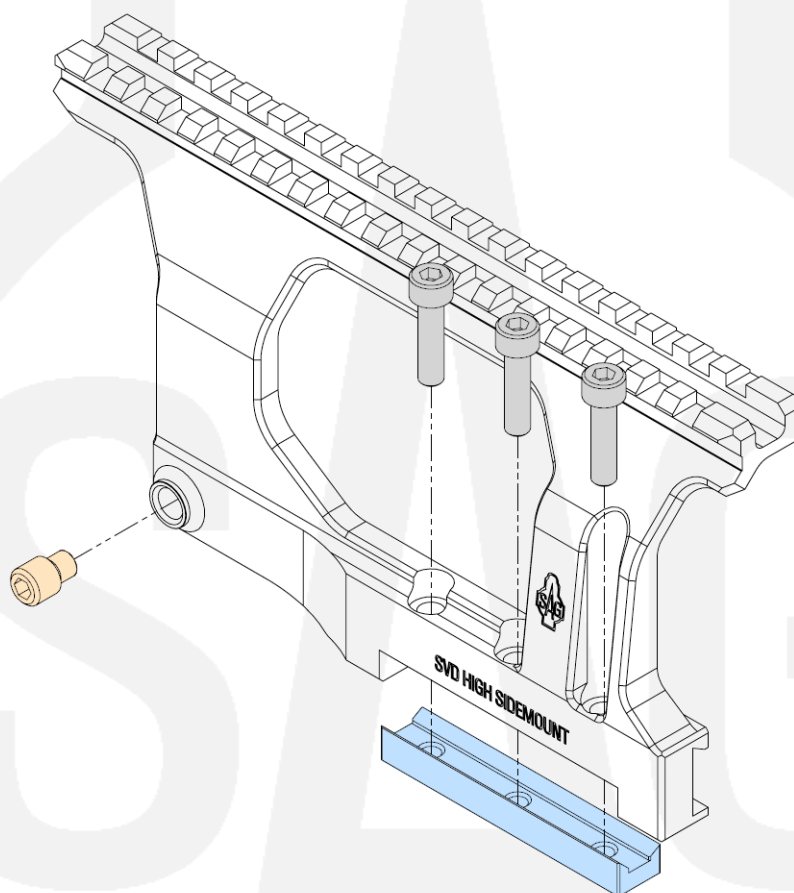

■ clamping bar ■ M5 bolt ■ locking screw M8*

* screw in slightly until touching the receiver

Mounting method

The sidemount is secured to the receiver side rail in this way:

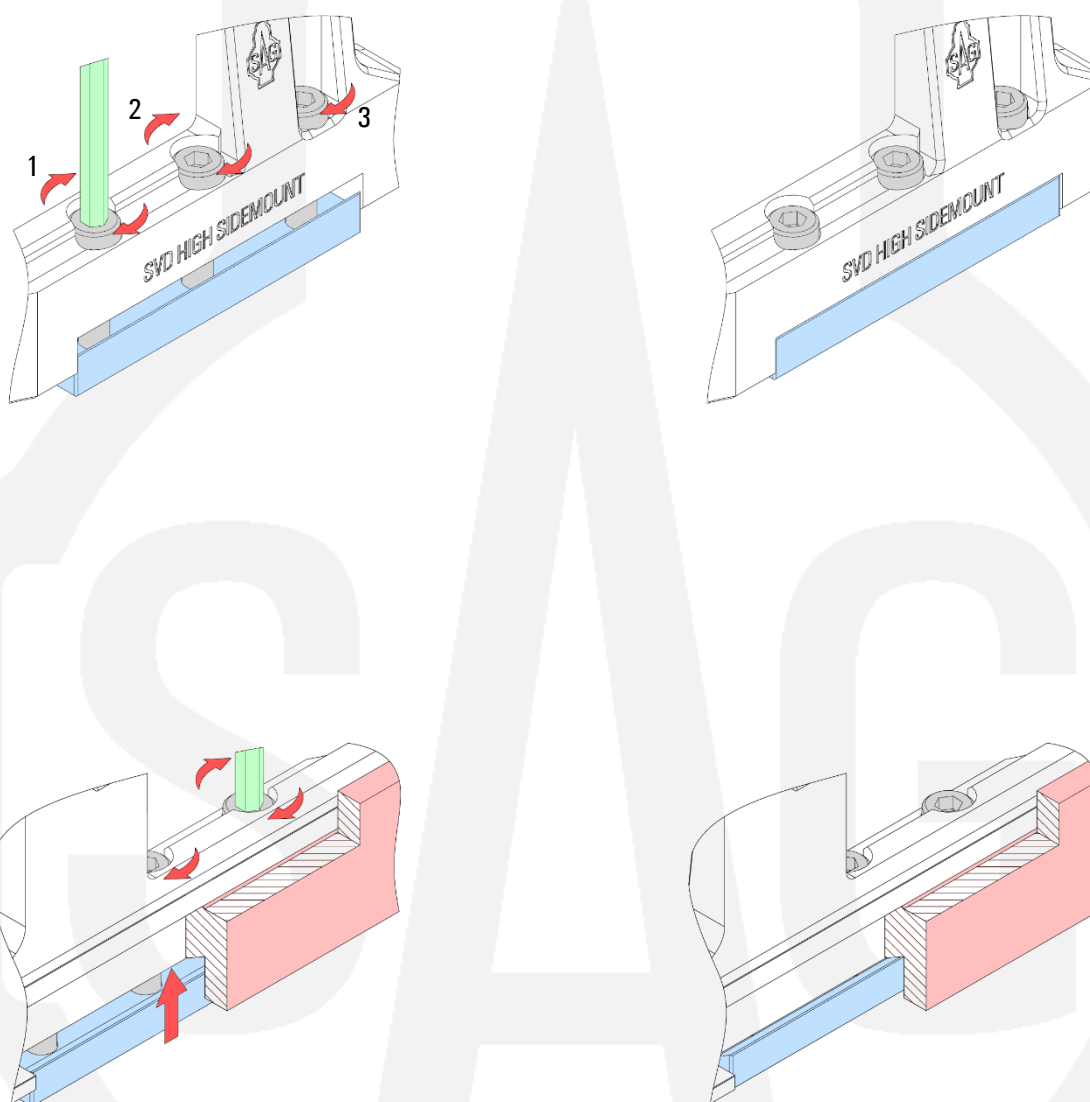

■ clamping bar ■ M5 bolt ■ 4 mm hex key ■ side rail

Tightening torque: 35 inch pounds (4 N·m)

All screws must be tightened in specified order with equal torque in two steps:

1. To the stop.
2. To the specified torque value.

SIDEMOUNT FOR SVD LOW

Design

art.: S20021

The locking mechanism consist of three parts:

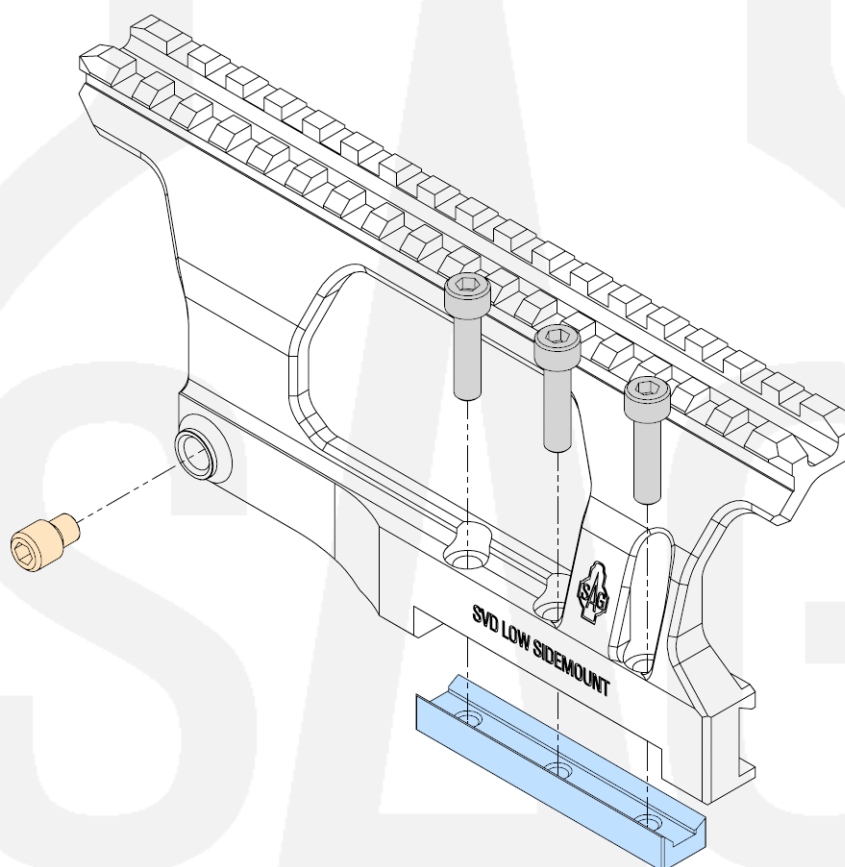

■ clamping bar ■ M5 bolt ■ locking screw M8*

* screw in slightly until touching the receiver

Mounting method

The sidemount is secured to the receiver side rail in this way:

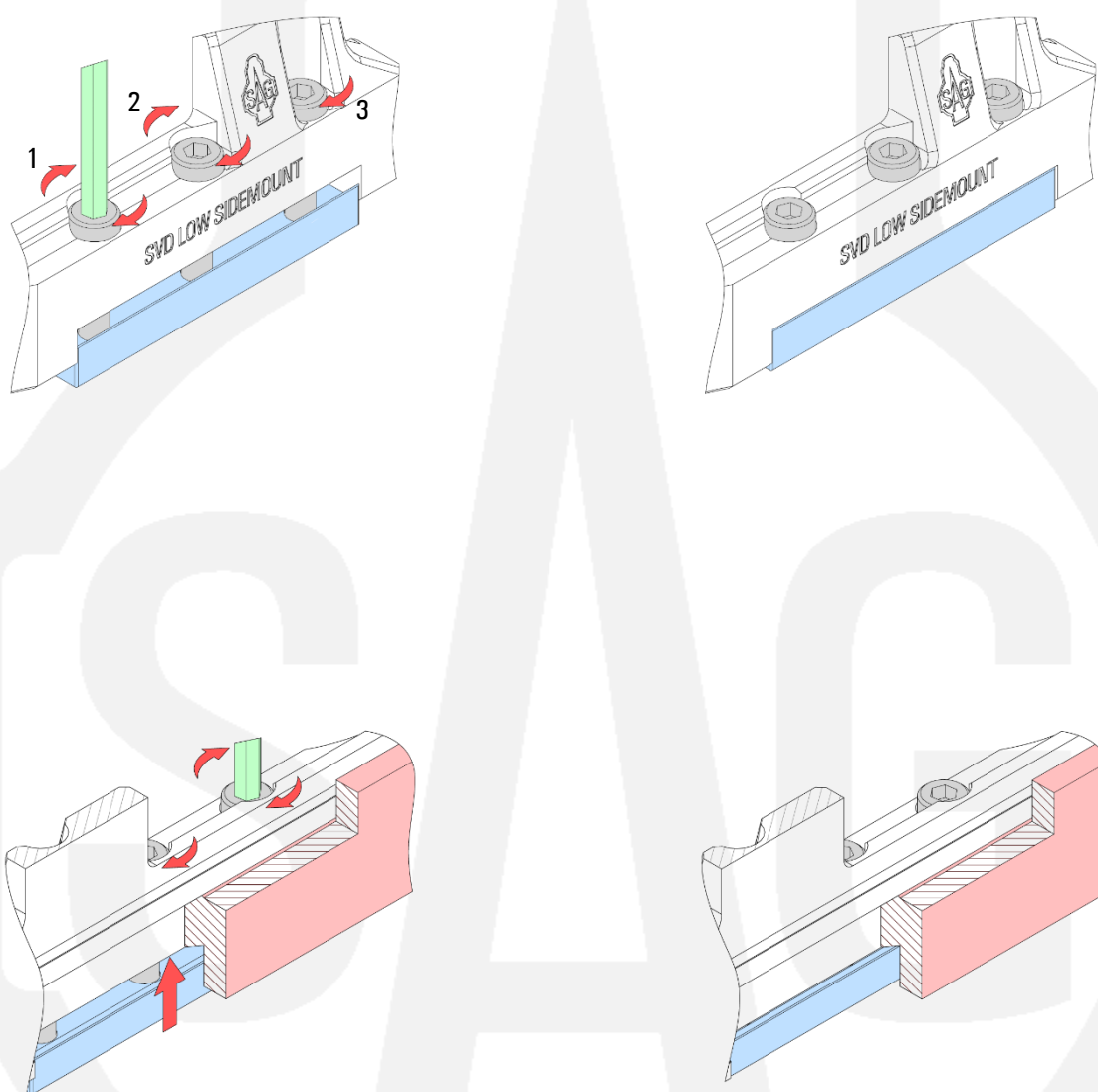

■ clamping bar ■ M5 bolt ■ 4 mm hex key ■ side rail

Tightening torque: 35 inch pounds (4 N·m)

All screws must be tightened in specified order with equal torque in two steps:

1. To the stop.
2. To the specified torque value.



Manufacturer

Sureshot Armament Group, USA
1521 Mark St, Elk Grove Village, IL 60007

E-mail: info@sureshot-usa.com
Phone: 630-594-4990

